



Submittal Data Sheet

6.0-Ton Concealed Ceiling Unit

FXMQ72MVJU

PERFORMANCE

Indoor Unit Model No.	FXMQ72MVJU	Indoor Unit Name:	6.0-Ton Concealed Ceiling Unit
Type:	Ducted	Rated Cooling Conditions:	Indoor (°F DB/WB): 80 / 67 Ambient (°F DB/WB): 95 / 75
Rated Cooling Capacity (Btu/hr):	72,000	Rated Heating Conditions:	Indoor (°F DB/WB): 70 / 60 Ambient (°F DB/WB): 47 / 43
Sensible Capacity (Btu/hr):	56,980	Rated Piping Length(ft):	
Cooling Input Power (kW):	1.490	Rated Height Separation (ft):	
Rated Heating Capacity (Btu/hr):	81,000		
Heating Input Power (kW):	1.49		

INDOOR UNIT DETAILS

Power Supply (V/Hz/Ph):	208-230 / 60 / 1	Airflow Rate (H/L) (CFM):	2047/1,764
Power Supply Connections:	L1, L2, Ground	Moisture Removal (Gal/hr):	
Min. Circuit Amps MCA (A):	9.5	Gas Pipe Connection (inch):	3/4
Max Overcurrent Protection (MOP) (A):	15	Liquid Pipe Connection (inch):	3/8
Dimensions (HxWxD) (in):	18-1/8 x 54-3/8 x 43-5/16	Condensate Connection (inch):	1
Net Weight (lb):	302	Sound Pressure (H/L) (dBA):	49/46
Ext. Static Pressure (Rated/Max) (inWg):	/ 0.95"	Sound Power Level (dBA):	

Submittal Data Sheet
 6.0-Ton Concealed Ceiling Unit
 FXMQ72MVJU

DIMENSIONAL DRAWING

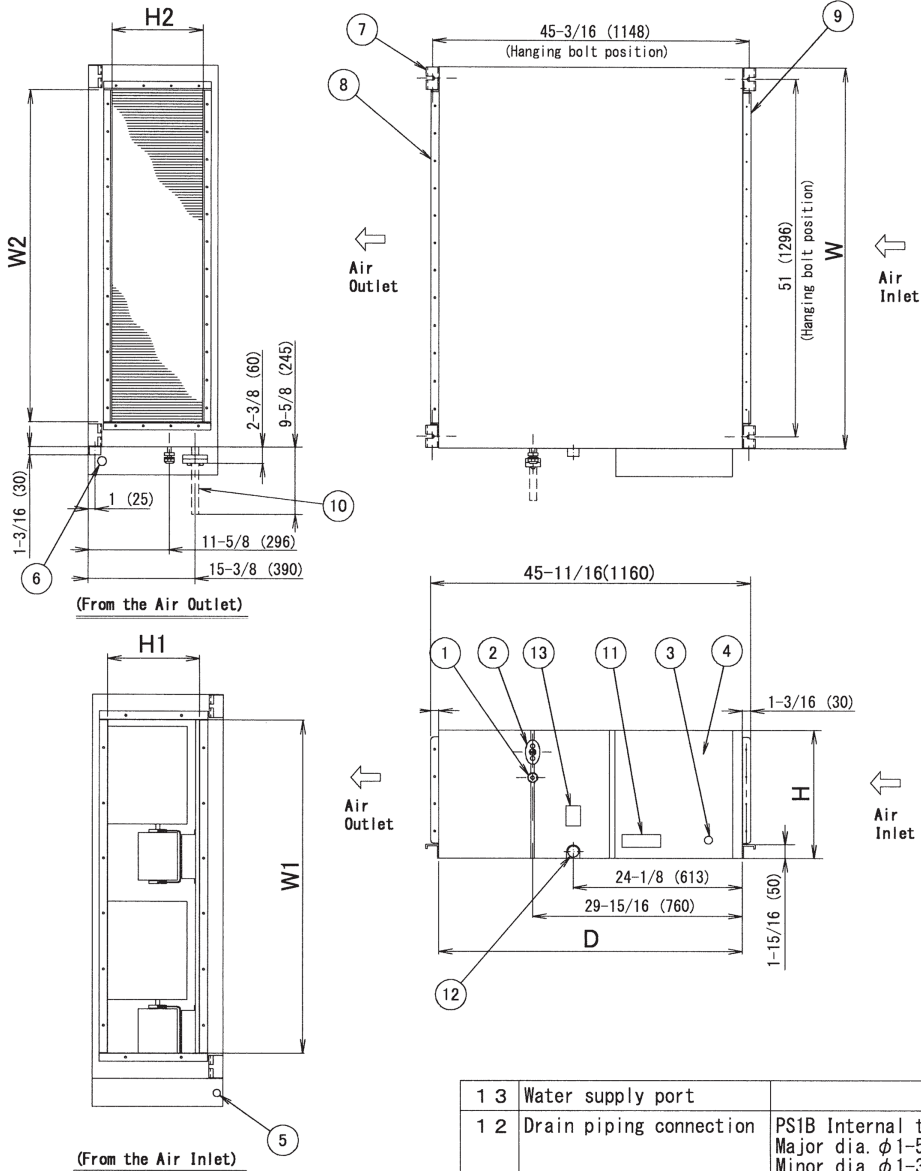

H	18-1/2 (470)	
W	54-5/16 (1380)	
D	43-5/16 (1100)	
Air Inlet	H1	13 (330)
	W1	47-1/4 (1200)
Air Outlet	H2	13 (330)
	W2	47-1/4 (1200)

Indoor unit	Gas side	Liquid side
FXMQ72MVJU	φ3/4 attached piping	φ 3 / 8
FXMQ96MVJU	φ7/8 attached piping	φ 3 / 8

1 3	Water supply port	
1 2	Drain piping connection	PS1B Internal thread Major dia. φ1-5/16, Minor dia. φ1-3/16
1 1	Name plate	
1 0	Attached piping	Brazing
9	Air Inlet flange	
8	Air Outlet flange	
7	Hook	M10
6	Transmission wiring connection	
5	Power supply wiring connection	
4	Switch box	
3	Ground terminal	M5(Inside switch box)
2	Gas pipe connection	Attendant piping connection
1	Liquid pipe connection	Flare connection
ITEM	PART NAME	REMARK

Note: For additional dimensional data and clearance information, refer to Engineering Data

Daikin North America LLC, 5151 San Felipe, Suite 500, Houston, TX, 77056